



# Ramada Hotel & Resort Kidderminster

Set in twenty acres of delightful countryside and within easy access of Birmingham, Worcester and the Welsh borders, this Victorian hotel has a charming atmosphere of style and elegance. The hotel boasts an excellent choice of conference and special event rooms and can accommodate between 10 and 450 guests.

# Conferences

## that work



**At the Hotel & Resort Kidderminster the Summit Conference Centre comprises 6 conference rooms suitable for hosting discreet boardroom meetings or conferences for up to 450 delegates. There are also a number of smaller rooms available should you require them.**

### **Flexible to your needs**

The hotel's business services and conference facilities will meet the highest expectations with your meeting room set up exactly to your specifications. What's more, you'll find within your meeting room the Summit Toolbox, perfect for any stationery bits and pieces you may need throughout your meeting, there's also secretarial support available should you require it. There is a variety of equipment available to hire for your meeting, simply let us know what you need and we'll arrange it for you. The hotel also has free parking for 150 cars.

### **Food for thought**

Early start? Then why not enjoy breakfast baguettes served in your meeting room, to ensure your delegates are ready for the day ahead. Throughout the day you'll be able to take advantage of the delicious breakout foods available when you stop for coffee.

Lunch can be served direct to your meeting room, or you can enjoy your meal in the Court Restaurant which serves a great choice of delicious food.

### **Relax and unwind**

Enjoy a drink in the friendly surroundings of the Court Bar and terrace - perfect for relaxing after a hard day.

### **Seb Coe Health Club**

A visit to the Seb Coe Health Club is a great way to relax at the end of the day. You'll find a 25m swimming pool, health & beauty salon, hair studio, aerobic and fitness assessment centre, all weather terrain courts and, of course, the gym, if you want to work out.

### **And there's more...**

Of course, it's not just conferences that we're renowned for; whether you're booking a wedding or other celebration, why not give us a call. With the services of an experienced Special Event Co-ordinator, we can ensure your event is one to remember. Ask about the Just Married and Good Times programmes.

- 44 bedrooms
- 6 conference rooms
- Largest meeting room holds 450 delegates
- Seb Coe Health Club
- Court Restaurant & Terrace Bar
- Free parking for 150 cars
- Located within easy access of Birmingham and Worcester

# Rooms that deliver

With a choice of 6 major meeting rooms, there's a meeting room for you, whatever your requirements. To give you an indication of the various rooms available, here are the floor plans for some of them:

## Balmoral

The Balmoral is a versatile suite with plenty of space for exhibitions, specialised events and large meetings for up to 450 delegates.

- Natural daylight
- Wheelchair access
- Air conditioning

## Windsor

An excellent training venue which can comfortably seat 40 delegates boardroom style. It also has excellent natural lighting.

- Natural daylight
- Air conditioning

## Kings Suite

This ideal boardroom can comfortably accommodate up to 10 delegates and has excellent natural lighting.

- Natural daylight

## Penny Black

Ideal for meetings of up to 24 delegates, you'll also find plenty of syndicate areas outside the main room.

- Natural daylight
- Wheelchair access

## York & Kent

Ideal for smaller meetings and training needs for up to 16 delegates.

- Natural daylight

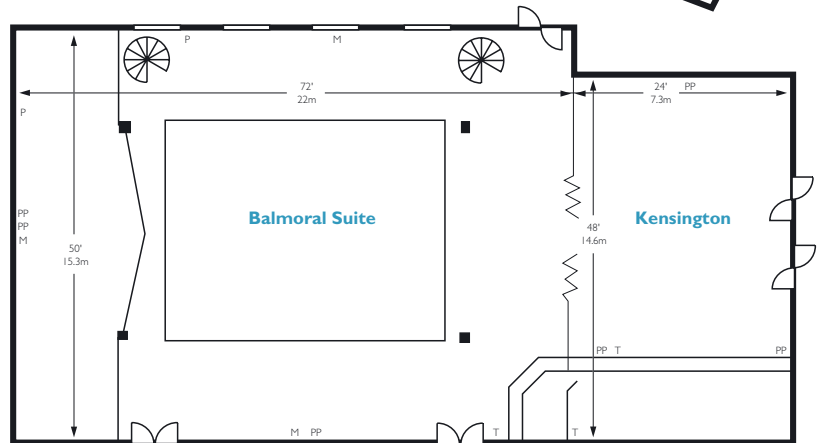
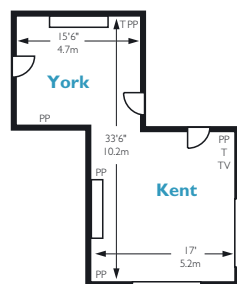
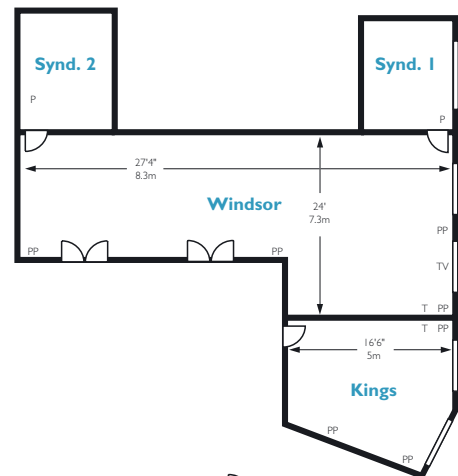

## Key

- P – Power Point
- PP – Double Power Point
- T – Telephone
- TV – Television/Video Socket

	Balmoral	Kensington	Windsor	York & Kent	Kings Suite	Penny Black
Floor location	G	G	1st	1st	1st	G
Theatre	450	90	90	30	16	40
Classroom	150	30	36	8	8	16
Boardroom	80	35	40	16	10	24
U-shape	80	30	36	12	-	20
Reception/buffet	600	-	-	-	-	170
Dinner	340	50	80	16	10	80
Dinner Dance	300	-	70	-	-	-
Height (m)	5.1	2.6	2.67	3	2.6	2.5
Obstacles (i.e. pillars)	yes	no	no	no	no	no
Windows	yes	no	yes	yes	yes	yes
No. 13 amp sockets	4	3	5	5	3	3
Phone points	1	0	1	2	1	1



Ramada Hotel & Resort Kidderminster  
Habberley Road  
Bewdley  
Nr Kidderminster  
Worcester  
DY12 1LJ  
Tel: 01299 406400 Fax 01299 400921  
Email: [csales.kidderminster@ramadajarvis.co.uk](mailto:csales.kidderminster@ramadajarvis.co.uk)  
[www.ramadajarvis.co.uk](http://www.ramadajarvis.co.uk)

### Location

From M5  
Junction 6 follow A449 to  
Kidderminster (or elephant sign to  
West Midlands Safari Park). Pass  
Safari Park on your left - at island  
take 2nd exit to Bewdley. 200  
yards further on turn sharp right  
signposted Wolverley B4190. The  
hotel is 400 yards on your right.

